

M/V MS. CAROLINE



Crew Boat - Fast Supply Vessel

Delivered May 2007

DP I

REGISTRATION

Operator	Gulf Offshore Logistics, LLC
Delivered	May - 2007
Builder	Breaux's Bay Craft, INC
Flag	USA
Classification	U.S.C.G. Certified ABS Loadline
Official No.	1199076

MAIN PARTICULARS

Length Overall	175ft	53m
Beam	31ft	9.70m
Depth	17ft	5.2m
Light Draft	7ft	2.28m
Loaded Draft	14ft	4.27m
Deadweight		315 tons
Gross/Net		99 tons / 66 tons

CAPACITIES

Drill & Potable Water	51,575USG	195m3
Fuel	24,884USG	94m3

CARGO DECK

Length	108ft	33.00m
Width	27ft	8.23m
Clear Deck Area	2,916ft2	271m2

MACHINERY

Main Engines	(4) KT50 Cummins 1,800 BHP each
Reduction Gears	Twin Disc 2.93:1, MGX6848
Propellers	54" x 54" 4Blade Michigan Dyna Quad
Steering	Hydraulic Dual Pumps
Bow Thrusters	Thrustmaster 30" Tunnel
Bow Thruster Engines	30TT175H-AL 175 HP
Shafts	5" x 24' & 5" x 28' SS Aquamet 17
Rudders	(2) Foil Rudders W/6" Post
Generators	(2) 85 KW Stanford - 208/120 V
Generator Engines	(2) Cummins 6BTA 5.9-DM

PERFORMANCE

Speed Light Ship	29 Knots
Speed 110 Tons	27 Knots
Cruising Fuel Consumption	110 GPH

ACCOMMODATION

Cabins/Berths	4 Cabins / 6 Berths
Mess	(1) Seating of 6
Passengers	82 Business Class Seats

ELECTRONICS

Radar	(2) Furuno FR-8111
GPS	Furuno GP-31
SSB	SEA 235
VHF	(2) ICOM IGM 127/ICM59
Depth Sounder	(1) Datamarine D3001
Loud Hailer	(1) Horizon LH5
Dynamic Positioning	Frank Beier DP-1
Receiver	(1) Navtec NCR300A
E-Mail	OCENS
Communication	Iridium Sat Phone

FIRE FIGHTING

Fire/Rig Water Transfer-Berkeley 1,500 l/m
 B4JRBH 4" x 5" Front Mount
 400 GPM @ 450' Head
 Powered by 3306B Caterpillar Engine

OTHER FEATURES

A/C Units: Trane-Keel Cooled
 (2) 4 Ton Central W/Heat Stripes

NOTICE: The data contained herein is provided for convenience of reference to allow users to determine the suitability of the Company's equipment. The data may vary from the current condition of equipment which can only be determined by physical inspection. Company has exercised due diligence to insure that the data contained herein is reasonably accurate. However, Company does not warrant the accuracy completeness of the data. In no event shall Company be liable for any damages whatsoever arising out of the use inability to use the data contained herein.



M/V Ms. Caroline 175' DP1 FSV



BREAUSSANT CREFT, INC.
 1 LAURENCEVILLE, LA
 77050-3354
 TEL: 281-333-3333
 FAX: 281-333-3333
 WWW.BREAUSSANTCREFT.COM

PROJECT NO. 171-A-231
 SHEET 1 OF 28
 DATE 01/08/20
 DRAWN BY: [Signature]
 CHECKED BY: [Signature]

PROFILE

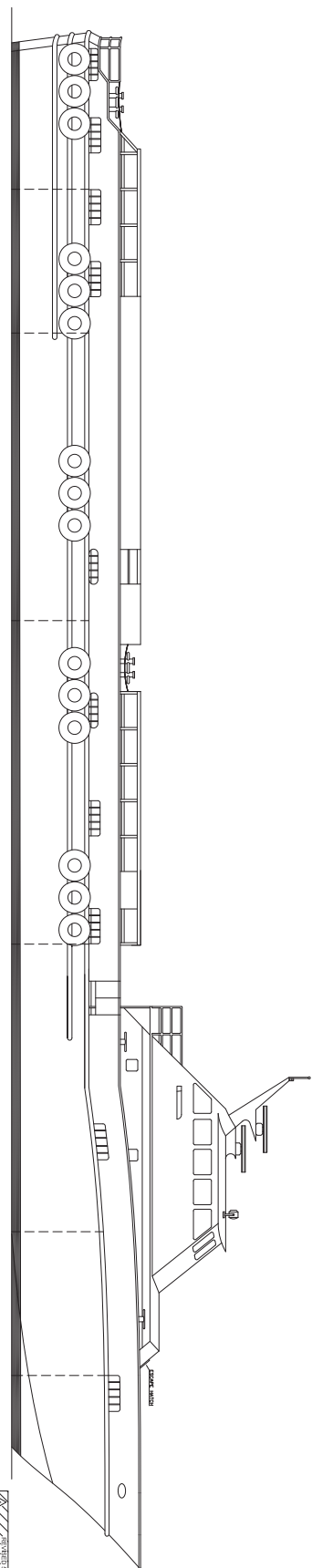

LOWER QUARTERS

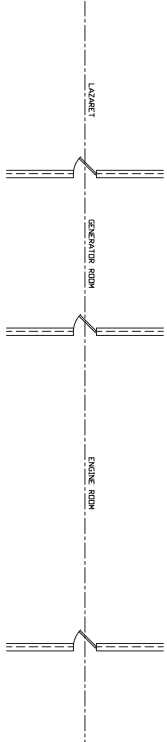
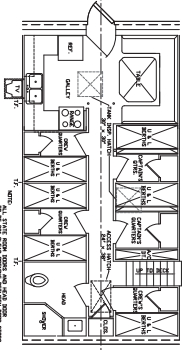

MAIN DECK

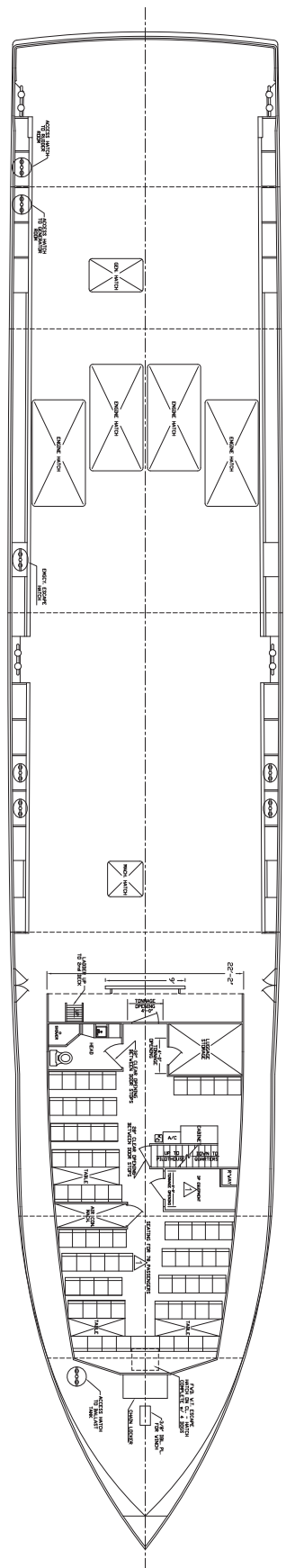

PILOTOUSE

